

Maxx T Connector

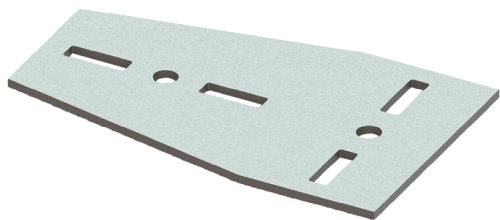

Features and Benefits

- T-connector for Maxx profiles
- advised to use from both sides always
- can also be used to strengthen Maxx constructions with a joint connection
- material: steel S235JR
- hot dip galvanized

Part No.	Type	B (mm)	H (mm)	s (mm)	d1 (mm)	d2 (mm)	Fa,x (N)	Fa,x2 (N)	Pack 1
DMC6589900	IP80	175	270	5	45x14	17	5,000*	8,250*	-
DMC6589901	IP100	175	290	6	45x14	17	5,000*	8,250*	-
DMC6589902	IP120	181	313	6	45x14	17	5,000*	8,250*	-

* = When using the connector with 1 pc. Maxx Hammerfix (65219214)
 ** = When using the connector with 2 pcs. Maxx Hammerfix (65219214)

